

Media: air – water – light oil  
 Pressure range: 1 to 100 bar max  
 Media temperature: 100° C max  
 Ambient temperature: -10° to +50° C  
 Media viscosity: 40 centistokes max  
 Mounting: vertical position, coil up  
 Weight (including coil): 620 g  
 Opening or Closing Time: 100mSec Max

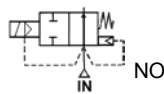

# 2/2 Brass N/OPEN

High Pressure 1/4, 3/8 & 1/2  
2 WAY SERVO ASSISTED

## TYPE 212240-0



### PRESSURE

Ø Port	Ø Orifice (mm)	Flow Rate Cv Ltr/Min	Pressure Rating (bar)			Seals	Max Media Temp °C	Part Number	List Price
			Min ΔP	Max ΔP air	Max ΔP water - oil				
3/8 BSP or 1/2 BSP	12	20	1	20		NBR EPDM FKM	60 100 100	21224010 + port + 0 + voltage 21224030 + port + 0 + voltage 21224020 + port + 0 + voltage	£330.58
			1		20	NBR EPDM FKM	60 100 100	21224110 + port + 0 + voltage 21224130 + port + 0 + voltage 21224120 + port + 0 + voltage	
			1	50		NBR EPDM FKM	60 100 100	21224210 + port + 0 + voltage 21224230 + port + 0 + voltage 21224220 + port + 0 + voltage	
			1		50	NBR EPDM FKM	60 100 100	21224310 + port + 0 + voltage 21224330 + port + 0 + voltage 21224320 + port + 0 + voltage	
			1	100		NBR EPDM FKM	60 100 100	21224410 + port + 0 + voltage 21224430 + port + 0 + voltage 21224420 + port + 0 + voltage	£551.86
			1		100	NBR EPDM FKM	60 100 100	21224510 + port + 0 + voltage 21224530 + port + 0 + voltage 21224520 + port + 0 + voltage	

### OPTIONS

Connector PG9 – DIN 43650 A  
 IP65 Coil  
 NPT thread  
 PTFE seal  
 Explosion proof enclosure: Protection II G/D EExdIICT6 ATEX



Included  
 Included  
 +£52.62  
 +£45.10  
 +£199.33  
 +5%

### ELECTRICAL DATA

Voltage (-10% + 15%) Continuous duty 100%	Coil Size	Power		Insulation class	Enclosure	Electrical connections
		Inrush	Holding			
~ 24 - 48 - 110 - 230 (50 or 60 Hz)	40	48 VA	24 VA	F 155°C	IP 65 with connector	3 spades DIN 43650A DIN 40050 VDE 0110
= 12 - 24 - 48 (DC)		14 – 20 Watts				

### CONSTRUCTION

Body, tube and internal parts: Brass  
 Seals and gaskets: NBR (Optional EPDM or FKM)  
 Moulded coil: Resin

### REPAIR KIT

Coil	40 + voltage
Complete plunger + O' rings + complete piston	KIT + valve part number

### OVERALL DIMENSIONS

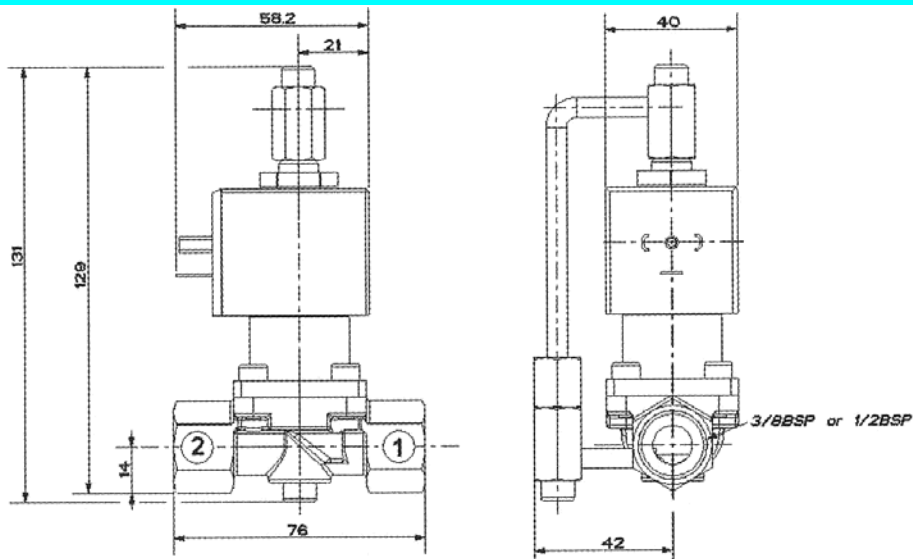

St Steel  
 212250  
 Page 56