

## Load-cell series ULB

Force from 0 ... 100 kg up to 0 ... 5000 kg



### Features

- DMS-load cell for industrial applications
- Available as standard- or Ex-device  
KEMA 02ATEX 1123X
- Bridge resistance 1100  $\Omega$
- Output signal 2 mV/V, exact sensitivity  
labelled on the type plate
- Basic accuracy 0.05 % (0.02 %)
- Repeatability 0.025 %
- Bridge supply max. 15 V DC
- Zero unbalance <5 %
- Operating temperature -20 ... 60 °C
- Maximum overload 200 %
- Breaking load 300 %
- Connection cable 6 m
- Material: stainless steel 1.4548 (17-4PH)
- Protection IP67



Bestellschlüssel: ULB -  1. -  2. -  3. -  4. -  5.

#### 1. Model

- 00 Standard for applications in Non-Ex-area
- Ex Model acc. to KEMA 02ATEX 1123X

#### 2. Model size

- 01 Nominal load 100 ... 500 kg t
- 02 Nominal load 1000 kg
- 03 Nominal load 2000 kg
- 04 Nominal load 3000 kg
- 05 Nominal load 5000 kg

#### 3. Nominal load

Please state in plain text (note model size)  
100 / 200 / 300 / 500 / 1000 / 3000 / 5000 kg

#### 4. Options

- 00 without option
- 01 Accuracy 0.02% (instead of 0.05 %)

## Load cell series ULB

### Connection diagram

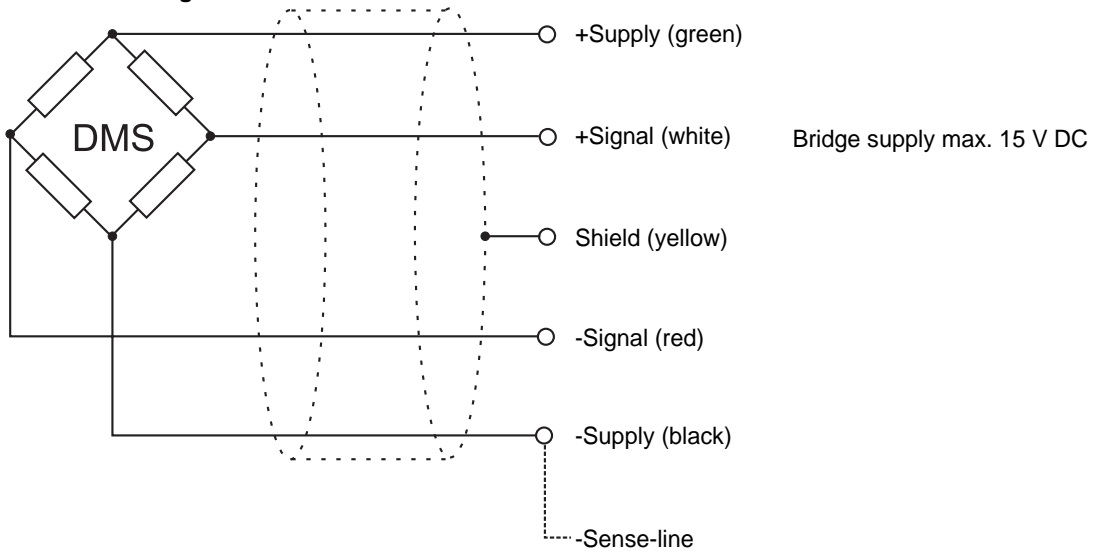

The sense line is used to compensate line resistance from load-cell to DMS-Transmitter. For distances more than 5 m it is recommended to use the sense line.

### Dimensions

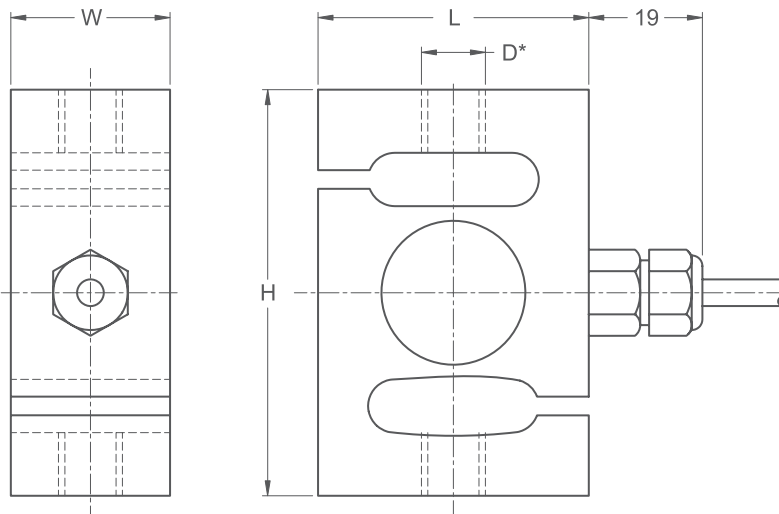

Dimension table [mm]

Model size	H	L	W	Thread D-M	UNF thread D-U	UNF thread D-H
01	76.2	49	30	M12	1/2-20	
02	76.2	49	30	M16	1/2-20	5/8-18
03	86.1	76.2	30	M16	5/8-18	
04	86.1	88.7	40	M20x1.5	3/4-16	
05	146	91.2	56.4	M24x2	1-12	