

Media: vacuum - air - water - light oil  
 Pressure range: 0 to 200 bar max  
 Media temperature: -10°C +100°C max  
 Ambient temperature: -20° to +50° C  
 Media viscosity: 50 centistokes max  
 Mounting: coil upright  
 Weight 450g  
 Opening & Closing time: 20mSec Max

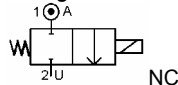

# 2/2 Brass

## N/CLOSED

### 2 WAY DIRECT ACTING

## TYPE WP

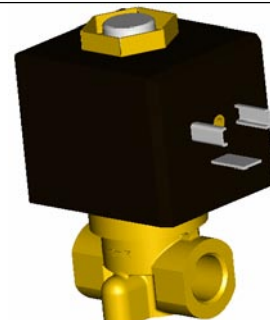

### PRESSURE

Ø Port	Ø Orifice (mm)	Flow Rate Cv Ltr/ min	Pressure Rating (bar)		Seals	Max Media Temp. °C	Part Number	List Price
			Min ΔP	Max ΔP				
1/8 BSP or 1/4 BSP	0.6	0.2	0	200	NBR FKM	100	W0.6 + seal + port + voltage	£109.04
	0.8	0.3	0	120		100	W0.8 + seal + port + voltage	
	1.0	0.5	0	50		100	W1.0 + seal + port + voltage	
	1.2	0.67	0	40	NBR FKM EPDM	100	W1.2 + seal + port + voltage	£94.25
	1.5	0.95	0	30		100	W1.5 + seal + port + voltage	
	2.0	1.6	0	20		100	W2.0 + seal + port + voltage	
	2.5	2.3	0	13		100	W2.5 + seal + port + voltage	
	3.0	3.0	0	10		100	W3.0 + seal + port + voltage	
	4.0	5.0	0	5		100	W4.0 + seal + port + voltage	
	5	7	0	3		100	W5.0 + seal + port + voltage	
6	9.7	0	2	100	W6.0 + seal + port + voltage			
3/8 1/2	12	30.0	0	0.5		100	W12 + seal + port + voltage	£103.03

### OPTIONS

Connector PG9 – DIN 43650 A  
 IP65 Coil  
 Explosion Proof Enclosure ATEX II 2 G/D EexdIICT6, IP65 85°C (Ambient T° from -20°C to +40°C)   
 NPT Thread  
 High Temperature coil  
 PTFE Seals

Included  
 Included  
 +£199.33  
 +£23.68  
 +£5.27  
 +£22.55

### ELECTRICAL DATA

Voltage (-10% + 10%) Continuous duty 100%	Coil Size	Power		Insulation class	Enclosure	Electrical connections
		Inrush	Holding			
~ 24 - 48 - 110 - 220 (50 or 60 Hz)	40	48VA	24VA	F 155°C	IP 65 with connector	3 spades DIN 43650 DIN 40050 VDE 0110
= 12 - 24 - 48 - 190 (DC)		14 - 20 Watts				

### CONSTRUCTION

Body: Brass  
 Tube and internal parts: Stainless steel  
 Seals and gaskets: NBR (Optional EPDM & FKM & PTFE)  
 Moulded coil: Resin

### REPAIR KIT

Coil	40 + voltage
Complete plunger	KIT + valve part number

### OVERALL DIMENSIONS

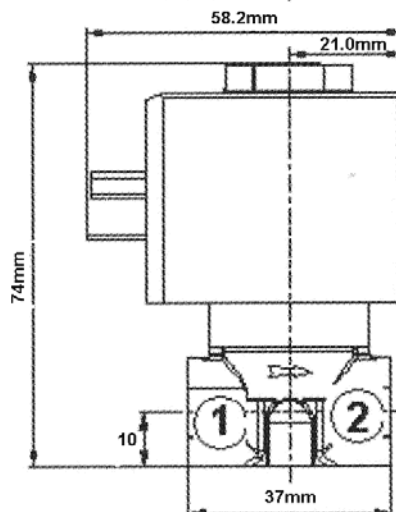
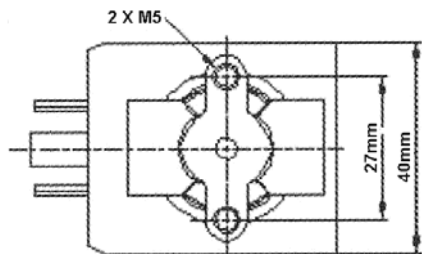

WI 500 BAR  
 Page 38