

Media: air – water – gas – light oil
 Pressure range: 0 to 7 bar max
 Media temperature: 100° C max
 Ambient temperature: -10° to +50° C max
 Media viscosity: 40 centistokes max
 Mounting: any position
 Weight (including coil): 270/370g
 Opening or Closing time: 20 mSec Max



3/2 Aluminium

N/CLOSED (1/8 BSP Exhaust) 3 WAY DIRECT ACTING

TYPE AM325



PRESSURE

Ø Port	Ø Orifice (mm)	Flow Rate	Pressure Rating (bar)			Seals	Max Media Temp °C	Part Number	List Price
		Cv Ltr/ min	Min ΔP	Max ΔP	Max Working				
1/4 BSP	2.2	2.3	0	6	7	NBR	60	PU32502A + voltage	£40.95
3/8 BSP	2.3	2.5	0	6	7	NBR	60	PU32503A + voltage	

OPTIONS

Connector PG9 – DIN 43650 A IP65 Coil NPT Thread	Included Included +10%
--	------------------------------

ELECTRICAL DATA

Voltage (-10% + 15%) Continuous duty 100%	Coil Size	Power		Insulation class	Enclosure	Electrical connections
		Inrush	Holding			
~ 24 - 110 - 230 - 380 (50 or 60 Hz)	30	26VA	14VA	F 155°C	IP 65 with connector	3 spades DIN 43650 DIN 40050 VDE 0110
= 12 - 24 - 48 - 110 - 220 (DC)		10 Watts				

CONSTRUCTION

Body: Anodised Aluminium
 Tube and internal parts: Stainless steel
 Seals and gaskets: NBR (Optional EPDM & FKM)
 Moulded coil: Resin

REPAIR KIT

Coil	30 + voltage
Complete plunger + O' rings	KIT325 + port + seal material

OVERALL DIMENSIONS

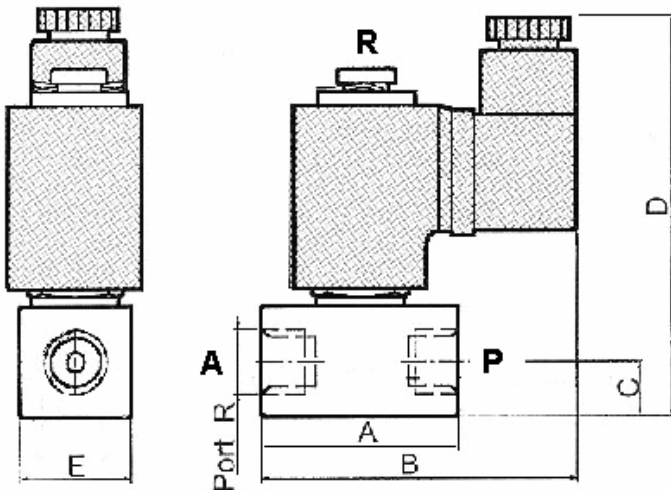

Model	Port A	A	B	C	D	E
AM325-02	1/4	45.0	72.0	12.75	90.5	25.5
AM325-03	3/8	54.5	77.0	10.8	95.5	31.8